

Compact Single Pole SPD  
**ProTec AQS 40 Series**  
 Class II • Type 2



Location of Use: Overhead Power Lines  
 Network Systems: TN, TT (only L-PE)  
 Mode of Protection: L-PE, N-PE  
 Surge Ratings:  $I_n = 20\text{ kA (8/20}\mu\text{s)}$   
 $I_{max} = 40\text{ kA (8/20}\mu\text{s)}$   
 IEC/EN Category: Class II / Type 2  
 Protective Elements: High Energy MOV  
 Housing: Compact Design  
 Compliance: IEC 61643-11:2011  
 EN 61643-11:2012

**Technical Data**

ProTec AQS 40/xxx		150	275	320	440
<b>Electrical</b>					
Nominal AC Voltage (50/60 Hz)	$U_o$	120V	230V	230V	440V
Maximum Continuous Operating Voltage (AC)	$U_c$	150V	275V	320V	440V
Nominal Discharge Current (8/20 $\mu\text{s}$ )	$I_n$	20 kA			
Maximum Discharge Current (8/20 $\mu\text{s}$ )	$I_{max}$	40 kA			
Voltage Protection Level	$U_p$	< 0.9kV	< 1.3kV	< 1.4kV	< 2.0kV
Response Time	$t_A$	< 25ns			
TOV Withstand 5s	$U_T$	216V	393V	393V	682V
Number of Ports		1			
<b>Mechanical &amp; Environmental</b>					
Temperature Range	$T_a$	-40 °F to +185 °F [-40 °C to +85 °C]			
Permissible Humidity	RH	5%...95%			
Connection Screw Torque	$M_{max}$	30.9 lbf-in [3.5 Nm]			
Connection Thread	(L/N)	M8			
Conductor Cross Section (max)	(PE)	6 mm <sup>2</sup> (Solid, Stranded) / 10 AWG (Solid, Stranded)			
Mounting		Connection Accessories			
Degree of Protection		up to IP 67			
Housing Material		Silicon			
Thermal Protection		Yes			
Fault Indication		Disconnected Cable			
<b>Order Information</b>					
Order Code		150	275	320	440
PROTEC AQS 40/xxx		509.210	509.211	509.212	509.213

## ProTec AQS 40 Series

### Internal Configuration

#### Legend

- L Line
- N Neutral
- PE Protective Earth

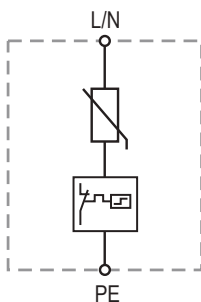

### Dimensions & Packaging [mm]

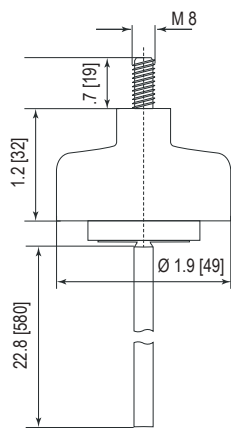

#### Dimensions & Packaging

ProTec AQS 40/xxx		150	275	320	440
Single Unit Weight	pounds	.246	.277	.286	.295
	grams	122	126	130	134
Packaging Dimensions (H x W x L)		15.3 x 14.9 x 11" [390 x 380 x 280 mm]			
Minimum Order Quantity		100 Units			

inches  
[mm]

Information contained in this document is subject to change at any time without notice.

