

In-line SPD for Coaxial & RF Systems
RayDat CP 7/16 Series
C1 • C2 • C3



IEC/EN Category: C1/C2/C3
 Protection: Impedance Matched
 Maximum Operating Voltage: 70, 180, 280V
 Maximum Peak Power: 40, 125, 300W
 Frequency Range: DC–2.5GHz
 Surge Discharge Ratings: I_n : 10kA, I_{max} : 20kA
 Impedance: 50Ω
 Insertion Loss: <0.2dB
 Return Loss: >20dB
 Termination: 7/16 Type (M-F)
 Housing: Bulkhead Installation, Shielded Enclosure
 Compliance: IEC/EN 61643-21

The RayDat CP 7/16 Series of coaxial surge protectors is intended to protect base station RF antenna systems and is suitable for frequencies from DC to 2.5 GHz.

It is designed for bulkhead or in-line installation. The careful design, low capacitance gas discharge arresters and high quality 7/16-type termination connectors ensure a minimum of insertion loss throughout the frequency band.

Transfer power is 40W to 300W continuous depending on coaxial cable protector voltage.

The CP 7/16 coaxial cable protector is designed in accordance with the IEC 61643-21: 2009 standards and regulations.

GDT is replaceable. The unit should be solidly mounted to the coaxial feed-through bulkhead, which should in turn present a low impedance path to ground for direct or partial lightning currents.

Technical Data

CP 7/16-MF		70V	180V	280V
Electrical				
Maximum Continuous Operating Voltage	U_c	70V	180V	280V
Maximum Peak Power	P_{max}	40W	125W	300W
C2 Nominal Discharge Current (8/20μs)	I_n		10kA	
Maximum Discharge Current (8/20μs)	I_{max}		20kA	
Residual Voltage at (1kV/μs)	U_{res}	<600V	<700V	<900V
Impedance	Z		50Ω	
Insertion Loss	I_L		<0.2dB	
Return Loss	R_L		>20dB	
Insulation Resistance of Protection	R_{iso}		>10GΩ	
Frequency Range	f_G		0–2.5 GHz	
Mechanical				
Temperature Range			-40 °C to +80 °C	
Connection			7/16 Male/Female	
Degree of Protection IEC/EN 60529			IP20	
Housing Material			Metal	
Order Information				
Order Code		70V	180V	280V
CP 7/16-MF-xxx		800 856	800 857	800 858

RayDat CP 7/16 Series

Internal Configuration

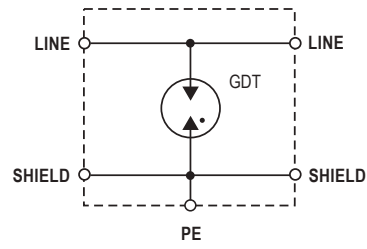

Legend

GDT Gas Discharge Tube

Dimensions & Packaging

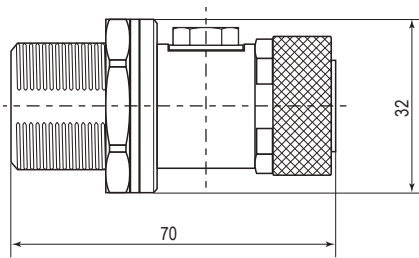

CP 7/16-MF	70V	180V	280V
Dimensions			
Weight per Unit		218 g	
Packaging Dimensions (Single Unit)		82 × 40 × 40 mm	
Minimum Package Quantity		100 pieces	